



MULBERRY PLACE, PINNELL ROAD, LONDON, SE9

 3

 1

 N



2850 sq
ft

£360,000 Freehold



A colonial style detached bungalow situated on a quiet pedestrian lane within the centre of this most sought after riverside village. The property is located close by to all the local amenit

- **Period Features**
- **9ft High Ceilings**

- **Approx 1/3 Acre Plot**
- **2 Double Bedrooms**

HENRY  **WILTSHIRE**

LONDON ♦ ABU DHABI ♦ HONG KONG ♦ SINGAPORE

CANARY WHARF OFFICE

+44 (0)20 7001 9160
www.henrywiltshire.co.uk
info@henrywiltshire.com

1-2 Laybourne House
Admirals Way
Canary Wharf, E14 9UH



GROUND FLOOR
APPROX. FLOOR
AREA 62.3 SQ.M.
(671 SQ.FT.)

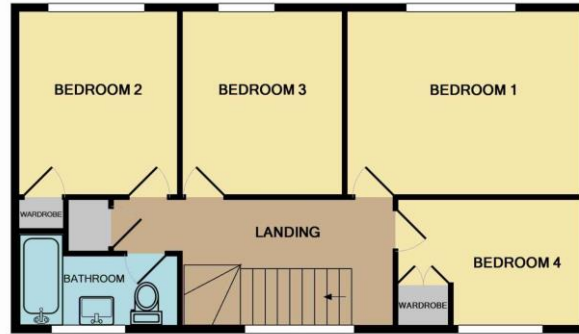

1ST FLOOR
APPROX. FLOOR
AREA 57.6 SQ.M.
(620 SQ.FT.)
TOTAL APPROX. FLOOR AREA 119.9 SQ.M. (1291 SQ.FT.)

Whilst every attempt has been made to ensure the accuracy of the floor plan contained here, measurements of doors, windows, rooms and any other items are approximate and no responsibility is taken for any error, omission, or mis-statement. This plan is for illustrative purposes only and should be used as such by any prospective purchaser. The services, systems and appliances shown have not been tested and no guarantee as to their operability or efficiency can be given
Made with Metropix ©2008

MULBERRY PLACE, PINNELL ROAD, LONDON, SE9

EPC: *current - 36* *potential 47*

Terms: *Freehold 97* *ground rent - £ 50 pa* *service charge - £ 6 pa*

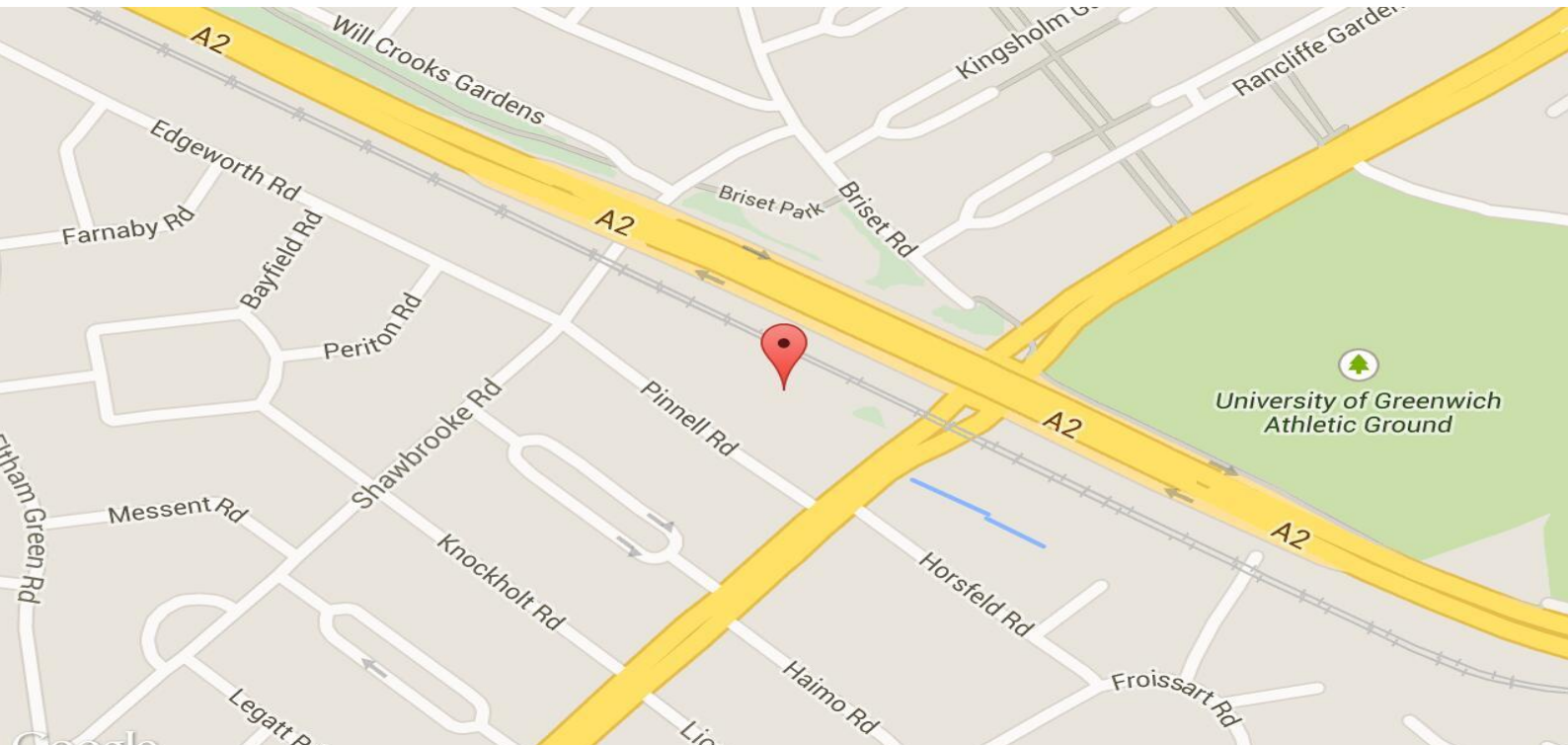

IMPORTANT NOTE: Whilst every care has been taken to ensure accuracy, the contents of this literature do not form part of or constitute a representation or warranty, and should be treated as a guide only as specification and details are subject to change. For accurate details the interested party is advised to consult the selling agent and/or satisfy themselves by inspection. This brochure and the description therein does not form any part of a contract, and while every effort has been made to ensure accuracy, this cannot be guaranteed.